

Madero

Natural Wood Finishes





A collection of impressive natural wood veneered acoustical finishes.

It is possible to specify natural wood veneered panels with exceptional acoustical performance. Ideal for both wall and ceiling applications, Madero finishes maximize the warmth and rich figure of natural wood veneers, while achieving superb acoustical control. The Madero line is available in a wide variety of natural wood veneers or custom paint colors. Custom veneer layups and toning can be specified.

Quadrillo®

Quadrillo is the premium finish in the Madero collection.

Solo-M®

The linear look of Solo fabricated to standard or custom ceiling modules.

Solo®

Solo is a grooved plank finish cut to fit on site.

Customized Applications

A selection of custom applications epitomizing Madero products warmth and endless versatility.

Quadrillo



Pear veneer, book matched, center balanced.

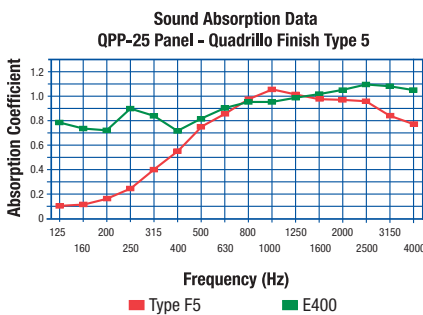

Although the percentage of open area of Quadrillo is only approximately 4%, the patented V-grooves create a four sided "funnel" effect that allows sound to arrive at a variety of angles thereby focusing the transfer of energy over a broader surface area of absorption material.

When observing from a normal viewing distance, the lineation or grooves essentially disappear rendering Quadrillo to appear as normal millwork.

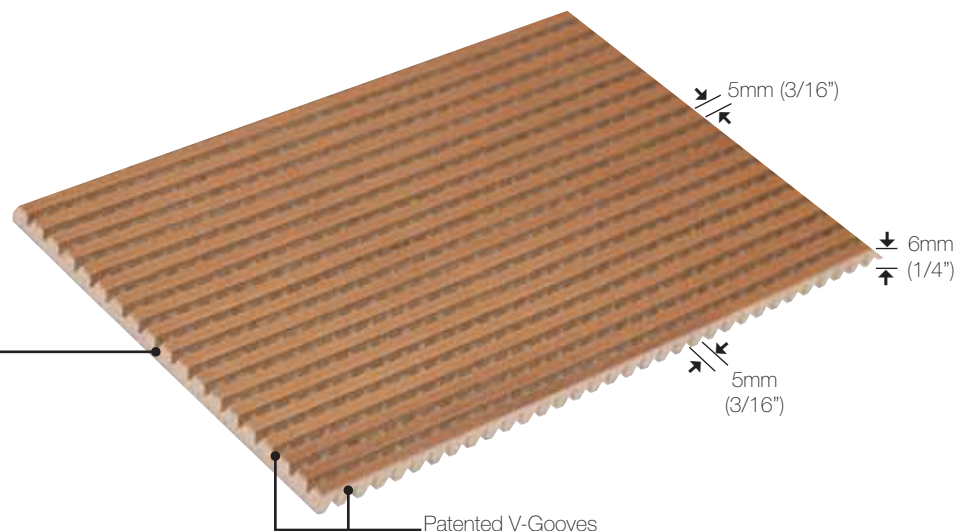
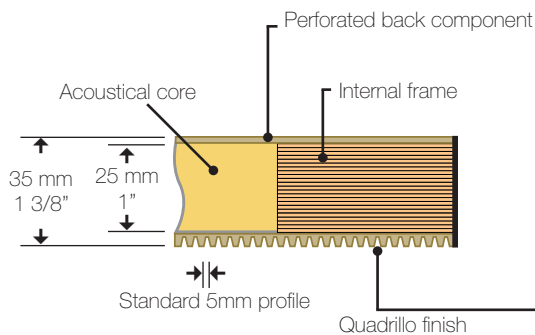

QPP-25 Panel - Quadrillo finish type 5

Madero

The natural qualities of wood greatly enhance this boardroom however its use has traditionally been limited because of its poor sound absorption properties. Quadrillo is available prefinished in clear lacquer or factory painted. Decoustics can provide custom lacquer toning, tinting and sheen to match other wood finishes. Quadrillo finished panels are frequently used in conjunction with millwork veneered panels, and in such cases it is highly recommended that a single finishing source be used to match toning and sheen. In these instances, Decoustics can provide unfinished panels.

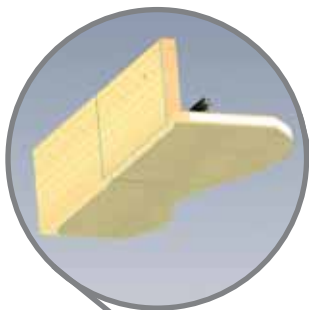

Integrated finishes with custom Designed Returns complete this boardroom ceiling design.

Quadrillo



Quadrillo finished panels in five separate sections installed between pilasters on side walls.

Quadrillo is available up to 1240 mm x 3050 mm (4' x 10'), however one should consider the potential problems associated with large units. Wood products have significant movement when subjected to climatic changes which can easily be overcome by using smaller panels. We typically recommend manageable sizes up to 20 square feet per panel. Quadrillo veneer lay up is produced as slip matched, quarter cut, as a standard. Other veneer cuts and lay up options are available. The minimum radius of an outside curve is 800 mm (approx. 32") to the face of the part. Quadrillo is available prefinished and unfinished. The color which is perceived is the total effect when viewed from a distance. It is important that the samples be approved based on the finished product and not just a sample of veneer only. Held close in hand, the variation could be quite evident but viewed at a moderate distance, the color will appear as one.



Quadrillo panels were specified for this medical facility auditorium. The concave absorptive and convex reflective panels give an exceptional acoustical performance while keeping the beauty and sophistication of natural veneered wood.

Madero



Create your own custom patterns by specifying profile spacings. Solid portions must be multiples of 5mm. Consult the factory for assistance.



Quadrillo

The grooving can be stopped to create an integral border of any width, or you can specify a traditional frame.



Madero



Quadrillo panels. Sequenced cherry, quarter cut and slip matched.

Quality Standards & Specifications

Quadrillo finish is made of high-density fibreboard (HDF) which is 30% denser than standard fiberboard and much more durable. The high-density fibers are more crisp in machining and not susceptible to felting or fluffing in the grooves.

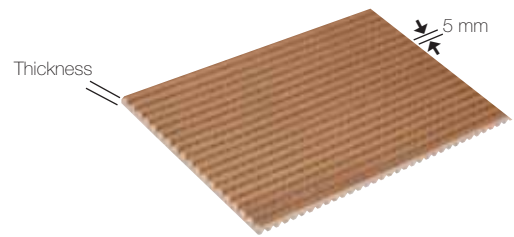

Quadrillo is finished using a two-step lacquer process that involves a “fill” first coat which is sanded and then top coated. The sheen value is high, consistently at a 30, and can be customized to any level. The lacquer and toning are brought into the grooves so the

Specifications - Walls

When Quadrillo panels are located in conjunction with millwork and non acoustic panels, it is highly recommended that it be specified in the millwork section-Division 6. This will enable better design and installation control where veneer sourcing and finishing can be better

Specifications - Ceilings

When Quadrillo panels are used for a ceiling application it is recommended to be specified in the specialty acoustics ceiling-Division 9. This will allow an experienced ceiling contractor to install Decoustics wood ceilings direct to substrate or with one of many different Decoustics engineered systems.



Quadrillo



Maple veneer, plain sliced, slip matched. Clear lacquer finish.

When used as a monolithic panel system, kerfed edges with splines are used to level the face. The reveal between panels is 3 mm (1/8") which simulates the "V" groove cut on 5 mm centres.

Mounting Detail Example

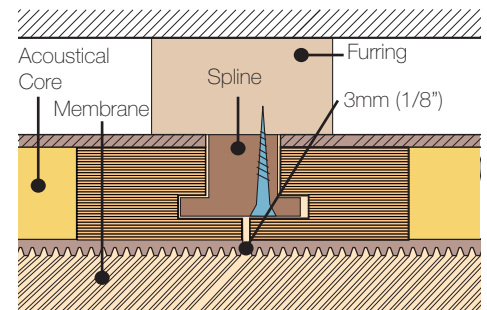

Climate Conditions

Quadrillo panels must be stored, installed and maintained only in a stable ambient environment (humidity min. 35% - max. 55%, temperature not to exceed 27°C/80°F).

Quadrillo panels must be allowed to acclimatize on site for 72 hours prior to installation.

Fire Classifications:

Quadrillo does not carry a "Class A" (ASTM-E84) composite designation. Few interior architectural wood products do. Quadrillo finish, acoustical core, and framing are Class A components. The veneer thickness is less than 1/28". The Quadrillo assembly is currently "Class C".

Refer to AWI handbook for more detailed data.

Note: Local codes fluctuate widely; check with authorities prior to use.

Weights:

QPP-19: 3.0 lbs./ft² – 14.75 kg/m²
QPP-25: 3.5 lbs./ft² – 17.1 kg/m²
QPP-50: 5.5 lbs./ft² – 26.85 kg/m²

FINISH TYPE 5	PANEL THICKNESS	FREQUENCY (Hz)						NRC	SAA
		125	250	500	1000	2000	4000		
Panel	Type F5 Mounting								
QPP-19	Panel 1-1/8" (28mm) Core 3/4" (19mm)	0.04	0.23	0.52	0.90	0.94	0.66	0.65	0.64
QPP-25	Panel 1-3/8" (35mm) Core 1" (25mm)	0.09	0.25	0.75	1.05	0.99	0.77	0.75	0.75
QPP-50	Panel 2-3/8" (60mm) Core 2" (50mm)	0.28	0.67	1.13	1.03	1.01	0.94	0.95	0.96
Panel	Type E400 Mounting								
QPP-19	Panel 1-1/8" (28mm) Core 3/4" (19mm)	0.78	0.77	0.61	0.86	1.04	0.70	0.80	0.82
QPP-25	Panel 1-3/8" (35mm) Core 1" (25mm)	0.79	0.90	0.81	0.95	1.05	1.05	0.90	0.91
QPP-50	Panel 2-3/8" (60mm) Core 2" (50mm)	0.80	0.87	1.00	1.07	1.06	1.00	1.00	0.98

Additional test results available

Madero



Stop grooved Solo-M wall panels designed with a custom grooved layout and simulated panel joints creating a unique visual appearance.



Fully grooved Solo-M panels with quarter cut slipped matched maple veneer. The panels are installed with direct mount hardware onto contractor supplied suspension.

Solo-M panels are a modified version of the standard Solo product and an economic consideration in lieu of Quadrillo finished panels which offers large panels, design versatility and full customization. Solo-M is produced as a panel rather than planks and has the same quality standards, acoustic performance and fire rating as Solo.

Solo-M is available prefinished in clear lacquer or unfinished for post application by others. Decoustics can provide custom lacquer toning, and sheen to match other wood finishes. Custom paint finishes are available. Veneer lay up is produced as slip matched, quarter cut as a standard. Other veneer cuts and lay up options are available.

Solo-M panels are available in both fully grooved and stop grooved formats which should be considered during the design process. Fully grooved panels create a monolithic appearance to the panel layout where as our stop grooving format adds an element of detail.

Solo-M maximum panel sizes vary depending on application and suspension methods.

Solo-M

Custom suspensions for Solo-M and Quadrillo panels

Ceilencio custom ceiling suspensions.



Ceilencio's easy downward access is demonstrated using Solo-M panels.

Conventional suspensions for Solo-M panels

Standard Lay-In

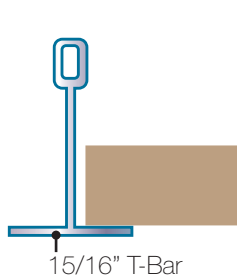

Tegular Edge Lay-In

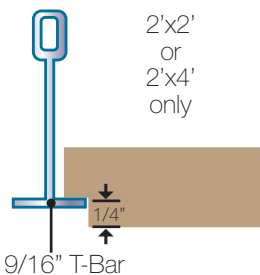

Screwslot Grid

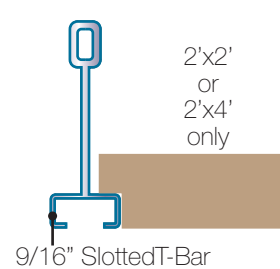

Concealed Lay-In

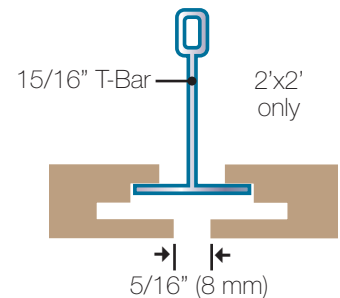

For all lay-in applications, a locking safety tether strap will be provided to secure panel to grid.

Direct Mount - Wall

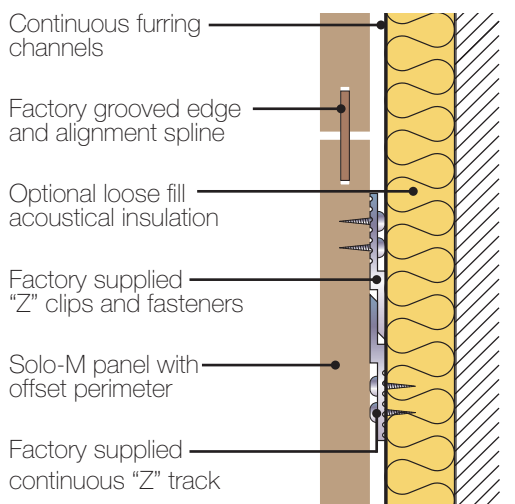

Direct Mount - Ceiling

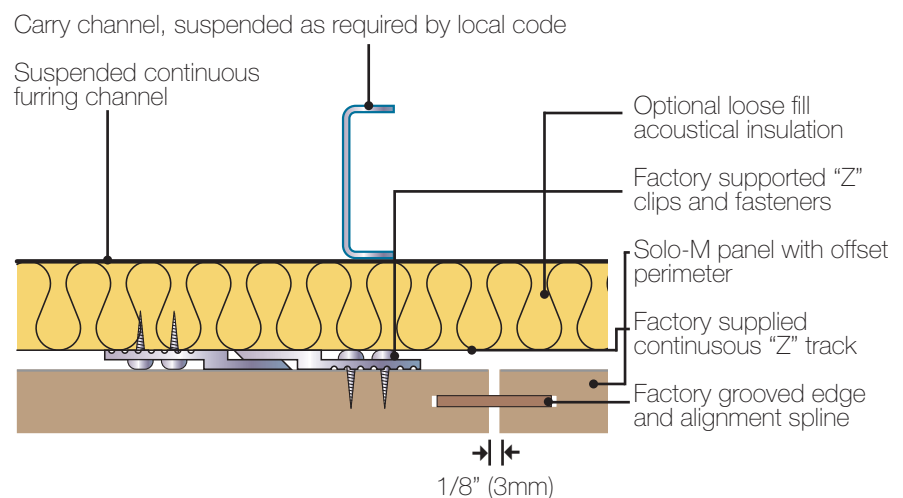

Madero

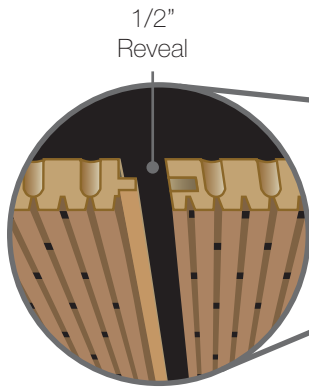

Solo is an acoustical wood plank consisting of a medium density fibreboard (MDF) finished in a natural wood veneer. The face is grooved, the plank is perforated from behind and the back is laminated with an acoustically transparent black mat. This prevents insulation color from reading through. The plank is cut to fit on site and is typically installed on wood or steel furring with insulation placed behind the wood planks. The plank width measures 7-9/16" (192 mm) wide x 120" (3050 mm) long and has tongue and groove edges which is mounted to wood or to steel furring channels.



Standard Solo 8 planks in maple veneer with aligned 1/2" reveal create a panelized appearance.

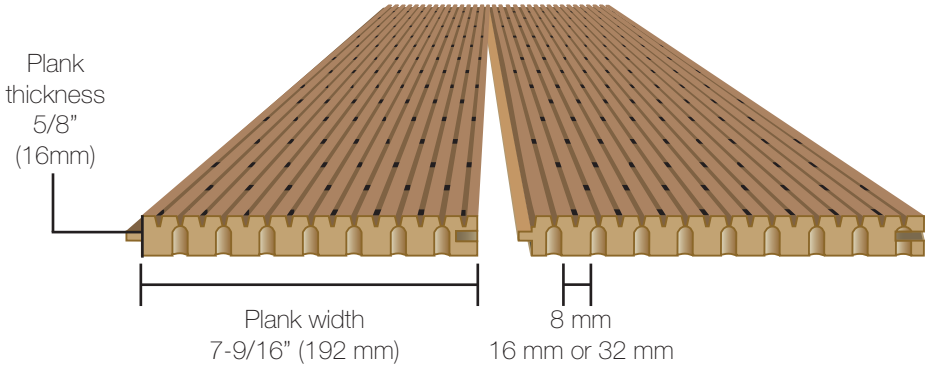

Solo

Solo is factory stocked in beech, cherry, and maple veneers quarter cut and pre-finished. Custom paint finishes are available. Solo is also available raw or pre-finished with a clear or custom toned lacquer.

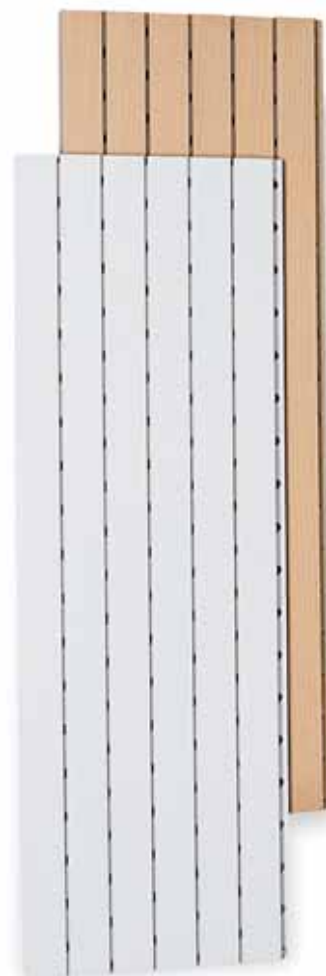
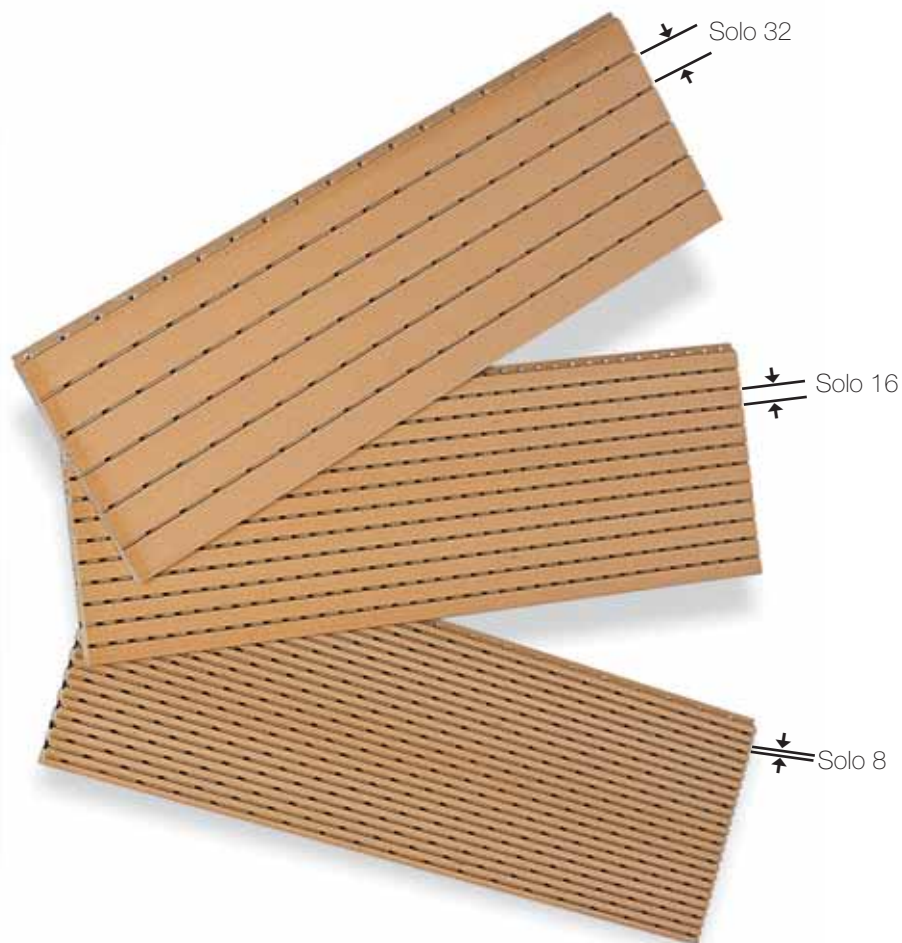

Solo 8 - 5/16" (8mm)
Solo 16 - 5/8" (16mm)
Solo 32 - 1 1/4" (32mm)

Madero



Solo with cherry veneer shown in a random matched aligned joint layout. The tongue and groove planks cannot be curved, however the plank can be indexed or stepped around a gentle radius to simulate the appearance of a curve. Narrower plank widths are available to provide a smaller radius. Since the veneer for Solo is randomly laid up, variations in veneer color and grain should be expected with Solo planks.



Solo-8 beech veneer quarter cut, slip matched with random match staggered joints. The overall appearance resembles tongue and groove flooring.

Quality Standards & Specifications

Solo is made of medium-density fibreboard (MDF). Solo is finished using a two-step lacquer process that involves a "fill" first coat which is sanded and then top coated. The sheen value is high, consistently at a 30, and can be customized to any level. The lacquer and toning are brought into the grooves so the surface color is the same as the substrate.

Climate Conditions

Solo planks must be stored, installed and maintained only in a secure ambient environment (humidity min. 35% - max. 55%, temperature not to exceed 27°C/80°F). Solo planks must be allowed to acclimatize on site for 72 hours prior to installation.

Specifications - Walls

When Solo planks and Solo-M panels are located in conjunction with millwork and non acoustic wall panels, it is highly recommended that it be specified in the millwork section- Division 6. This will enable better design and installation control where veneer sourcing and finishing can be better co-coordinated.

Specifications - Ceilings

When Solo planks and Solo-M panels are used for a ceiling application it is recommended to be specified in the specialty acoustics ceiling section-Division 9. This will allow an experienced ceiling contractor to install the wood ceiling products direct to substrate or with one of many different Decoustics engineered systems. To compliment standard Solo product, Decoustics has made available various pre-engineered accessories to enable ceiling contractors to complete unique wood ceiling concepts.

Solo Trim Accessories

In order to provide the finishing touches to your Decoustics Solo wall or ceiling installation, Decoustics also offers a selection of standard trims to compliment our Solo line of products. Available in a standard length of 120" [3050 mm] and in several standard widths, these trims have been designed to be utilized in either a picture frame format or as vertical return closure trim.

Available in real wood veneers or custom painted to match plank. All trims are composed of the same Class A fire rated MDF cores as our Solo products and are supplied with a factory applied clear coat fire retardant lacquer.

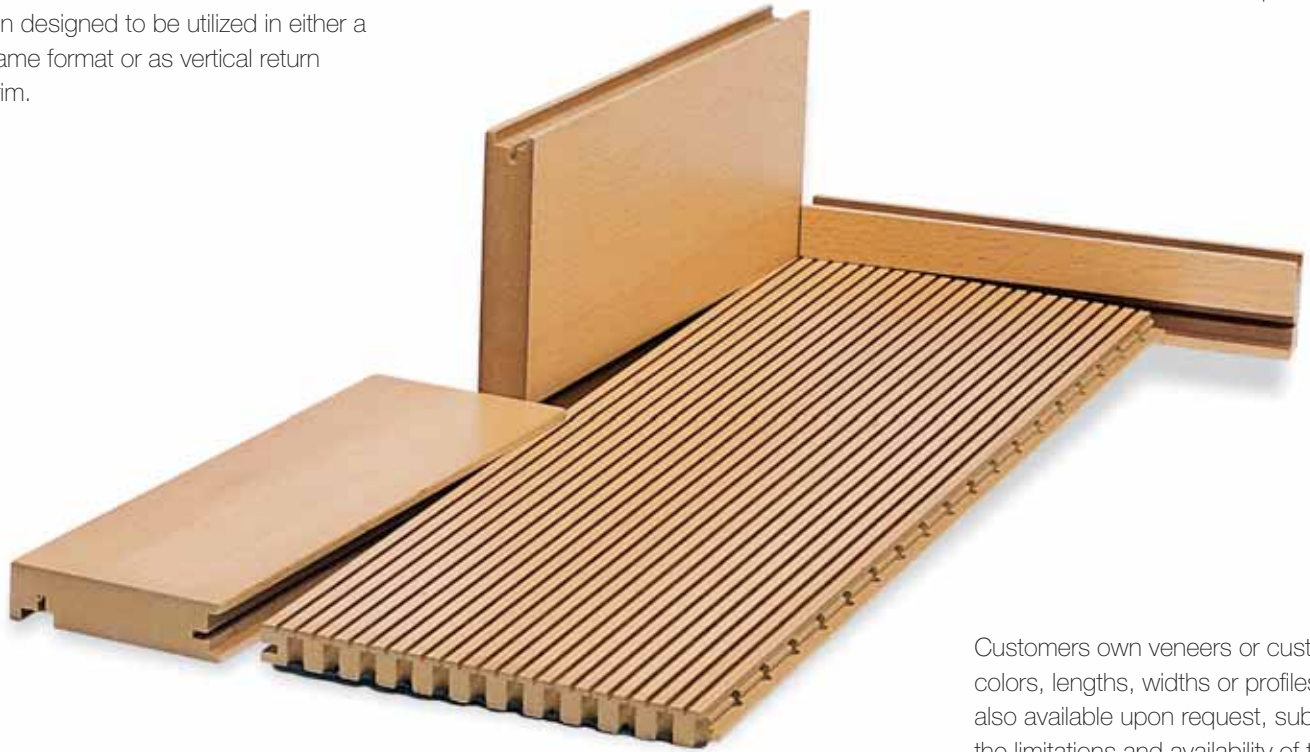

Customers own veneers or custom colors, lengths, widths or profiles are also available upon request, subject to the limitations and availability of the raw materials.

Please consult with your Decoustics rep or our factory for further information and to ensure correct specification criteria.

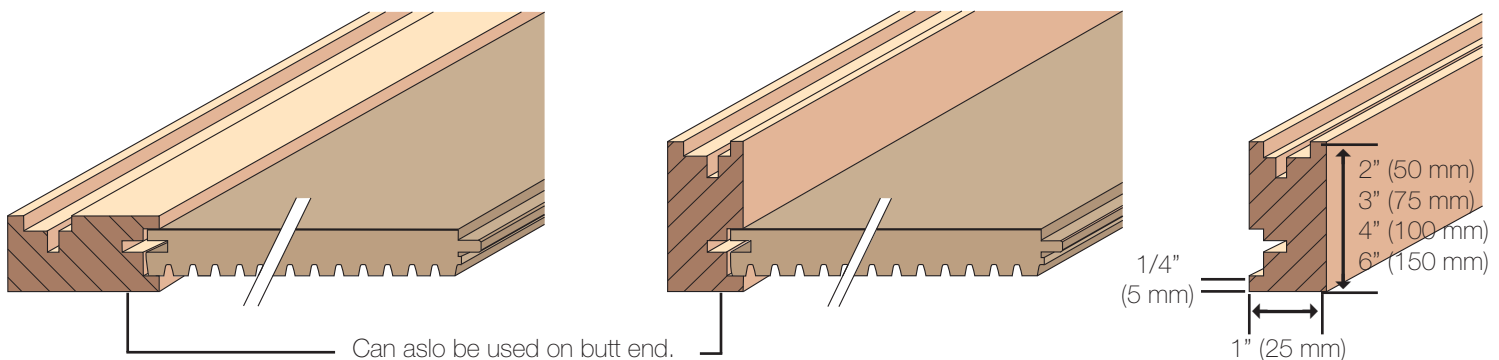

Note: Inside and outside corner trims are also available. Consult factory for other custom accessories.

Madero

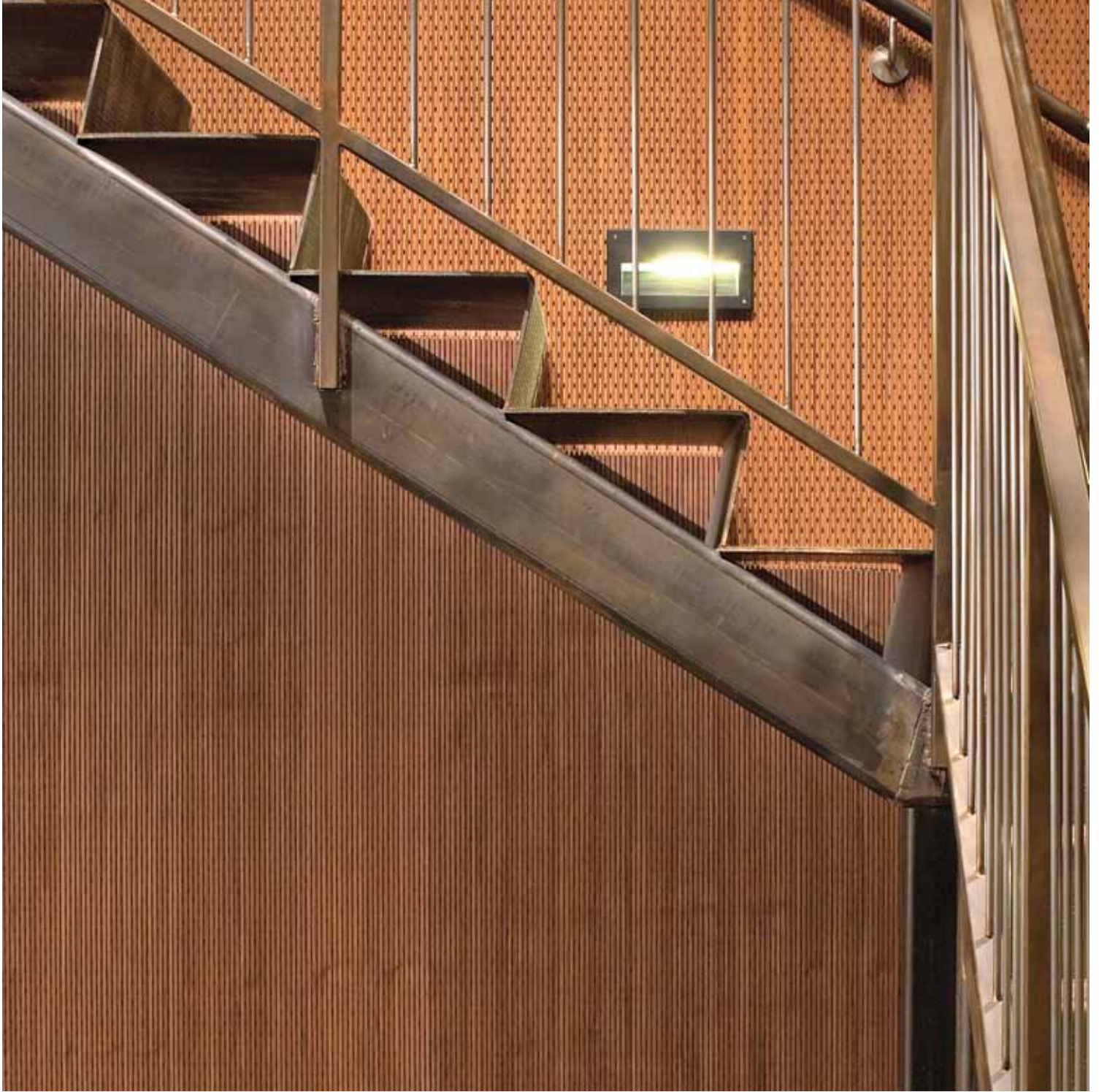

This upscale wall feature looks custom but was achieved with standard, field cut Solo planks in walnut veneer.



Custom reveals with coordinated trim, transform a standard Solo plank ceiling application into a custom design for this high-end retail space.

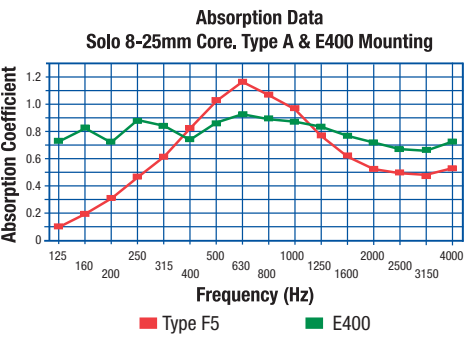

Type F5 -
represents a typical wall installation
Type E400 -
represents a typical ceiling installation

Weight:
Solo 8: 2.0 lbs./ft2 – 9.75 kg/m2

Solo M and Solo

Fire Treated: The plank core is Class A. The veneer thickness is less than 1/28th".
The lacquer finish applied is fire retardant.
Note: In the Fire Treated format, the Solo plank is "Class A".

FINISH	ACOUSTICAL INFILL	FREQUENCY (Hz)						NRC	SAA
		125	250	500	1000	2000	4000		
	Type F5 Mounting								
Solo 8	1" (25 mm)	0.10	0.45	1.03	0.96	0.51	0.51	0.75	0.73
Solo 8	2" (50 mm)	0.36	0.97	1.15	0.92	0.71	0.69	0.95	0.95
	Type E400 Mounting								
Solo 8	1" (25mm)	0.71	0.88	0.86	0.89	0.70	0.71	0.85	0.81
Solo 8	2" (50mm)	0.79	0.97	1.12	1.01	0.77	0.68	0.95	0.94

Madero



Highly custom Quadrillo ceiling with solid millwork features.



For custom applications, Decoustics will provide matching millwork edge and perimeter details along



Custom Quadrillo ceiling with framed panels and a unique detail at light fixture suspension.

Customized Applications



Quadrillo reception design.



Custom Quadrillo pedestal.

Doors and Cabinets

The Quadrillo door is a sandwich panel construction composed of the Quadrillo finish laminated to both face and back of a perimeter frame filled with a high performance acoustical core.



Custom Quadrillo cabinet doors.



Painted Quadrillo cabinet doors with integral offsets for latch and locks.

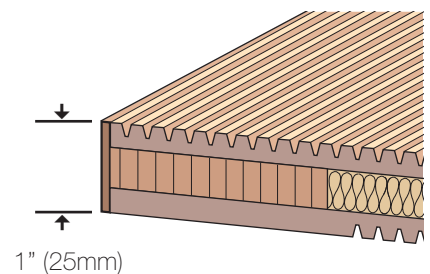
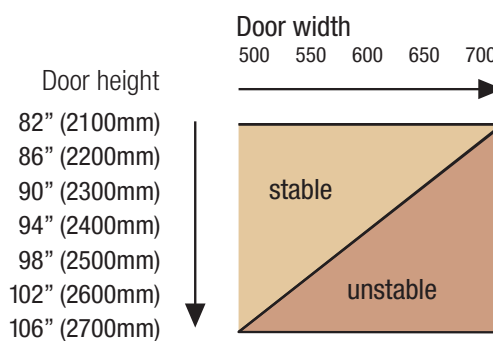

DECOUSTICS®
ECOPHON®
GYPTONE®
PERFORMA™



You can Be Certain™ that Decoustics will free you to bring your one-of-a-kind ceiling design to life. Its dramatic custom forms are engineered with exceptional precision to make even your most elaborate vision a possibility. And as part of CertainTeed Ceilings, we offer the expertise to help you ensure every space achieves ideal [Environmental Acoustics™](#) for a healthier indoor environment. Our solutions promote well being and productivity in any setting so every person can achieve their greatest potential. Through deep industry knowledge, continual innovation and sustainable efforts, we empower you to provide a sounder environment in any setting.